

**WARRANTY | MAINTENANCE | SPECIFICATIONS**





Independence Park - Telluride



Independence Park - Steamboat

# TABLE OF CONTENTS



Why Inspired?	3
Color Offerings	4-6
Liberty Park Warranty Information	7
Independence Park Warranty Information	8
WPC and SPC Maintenance and Cleaning Instructions	9
Cascade Park LVP Warranty, Maintenance, and Cleaning Information	10
Specifications	11-12
Accessories	13

# INSPIRED

## Why Inspired?

We have a unique view on flooring. We provide a great quality product at an affordable price. We source flooring that meets our rigorous performance and quality expectations like:

- **FloorScore and Carb2 Environmental Ratings**
- **UNILIN Locking Mechanism on all floating LVP**
- **20MIL Standard Wearlayer on SPC LVP**

Our flooring has features to give your home a great look; from large plank sizes to great and unique colors to micro-level. Inspired Flooring is truly

**flooring for your life/style.**

Cascade Park - Napa



Liberty Park - Prescott





# Liberty Park

6.5 MM SPC (5MM + 1.5MM)



Liberty Park  
Coastline



Liberty Park  
Spyglass

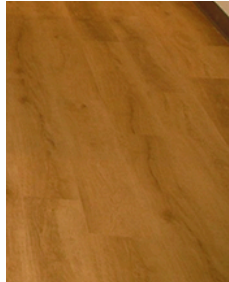

Liberty Park  
Victoria



Liberty Park  
Nantucket



Liberty Park  
Ashford



Liberty Park  
Napa



Liberty Park  
Union



Liberty Park  
Conway

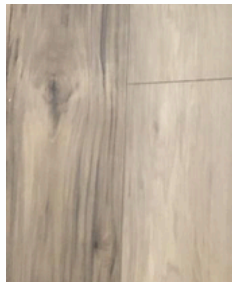

Liberty Park  
Crawford



Liberty Park  
Bridgewood

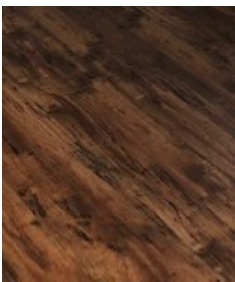

Liberty Park  
Worthington



Liberty Park  
Sandlewood



Liberty Park  
Grande Reserve



Liberty Park  
Prescott

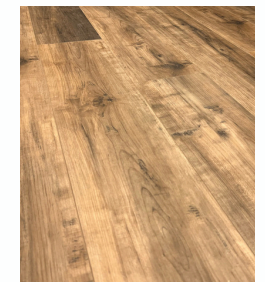

Liberty Park  
Monterey

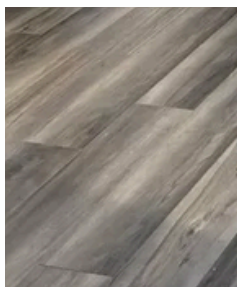

Liberty Park  
Hilldale



Liberty Park  
Oceanview



Liberty Park  
Summerset

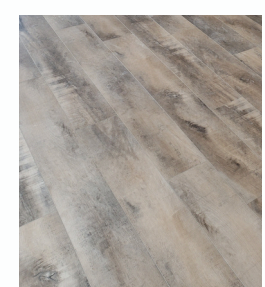

Liberty Park  
Westport



# Independence Park

5 MM SPC (4MM + 1 MM)



Independence Park  
Telluride

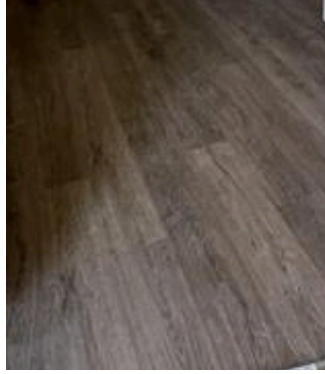

Independence Park  
Alta

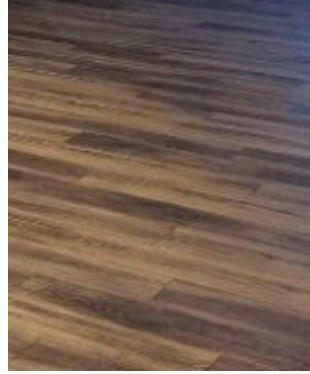

Independence Park  
Vail

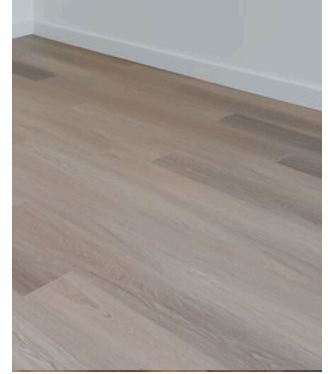

Independence Park  
Steamboat



Independence Park  
Aspen



Independence Park  
Tahoe



Independence Park  
Panorama



Independence Park  
Centennial



Alta



Telluride



# Cascade Park

2MM / 2.5 MM

Gluedown LVP

The Cascade Park Collection Luxury Plank flooring has been specifically value-engineered and custom-designed to meet the robust demands of property management and multi-family facilities. There are thousands of possible colors from the wide array of offerings. Most often, styles and patterns are manufactured for specific projects.

Crucially, the Cascade Park Collection prioritizes efficiency. Its design is centered on ease of installation, helping you minimize labor time and expedite unit turns. The result is a perfect balance of lasting style, superior durability, and practical value engineered directly for your bottom line.

**Overall Gauge:** 2mm or 2.5mm

**Wear Layer:** 12 mils or 20 mils

Finish UV Cured Urethane with suspended Microscopic ceramic particles

**Plank Size:** 7 inches wide and 48 inches long

**Packaging:** As Manufactured

**Installation:** Glue Down over substrate free of debris and defects greater than 1/16 inch

**Adhesive:** XL Brands / Taylor / Pinnacle pressure sensitive adhesive or similar

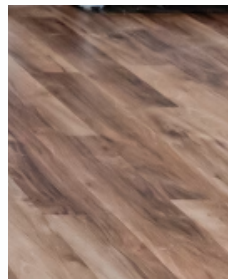

Cascade Park Summerset



Cascade Park Butternut

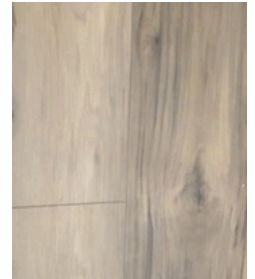

Cascade Park Crawford



Cascade Park Napa



Cascade Park Vegas



Cascade Park Hilltop



Cascade Park Colorado



Cascade Park Montana



Cascade Park Summerset



Cascade Park Vegas





# Liberty Park

25 YEAR RESIDENTIAL  
5 YEAR LIGHT COMMERCIAL

### **What this Residential and Light Commercial Limited Warranty covers:**

Inspired warrants that from the date of the original purchase throughout the length of the warranty (25 years - residential / 5 years light commercial) of the product you purchase, your SPC Floor:

- Will not stain
- Will not wear through (20 MIL Wearlayer)
- Will not fade as a result of direct sunlight or artificial light
- Will not absorb water

### **Structural Integrity Warranty:**

Inspired warrants to the original purchaser that this SPC/Vinyl/ Rigid Core product, in its manufactured condition, will be free from defects in material or workmanship including milling, assembly, and dimension. Any damage to the wear layer must be evident and visible measuring at least two (2) square inches.

What you should do if any of the above listed problems occur and you need warranty service: You (the original purchaser) should notify the authorized flooring dealer from which the original purchase was made of any defect no later than 15 days after discovering the defect but within the time period of this limited warranty. You (the original purchaser) must present to that authorized flooring dealer the following items for a warranty claim to be considered: A valid proof of purchase in the form of a sales receipt or other documents which establish proof of purchase. A detailed description of the problem and/or a photograph/sample that clearly shows the warranty problem.

Separation at the long or end joints may occur. This is typically a result of a site/installation condition and can be repaired easily by a flooring retailer/installer and this issue by itself will not give rise to a valid warranty claim.

### **What Inspired will do should you need warranty service:**

If Inspired honors a claim under this limited warranty, it will repair or replace, at its option, the cost of the affected flooring material only on a pro-rated basis (on original invoice of material only to original purchaser) for the duration of the warranty. The original purchaser shall be responsible for the difference between the replacement/repair amount and the pro-rated amount. If professionally installed, Inspired will pay the reasonable labor costs to perform the replacement or repair during the first one (1) year from the date of the original purchase. In the event that the color installed is no longer available, Inspired will authorize your dealer to replace the affected floor with another Inspired product of equal value and the pro-rated invoice value will be applied to the new Inspired product with the original purchaser being responsible for the difference, if any. The above described remedy is the purchaser's sole and exclusive remedy for claims under this limited warranty.

### **This Limited Warranty is subject to the following conditions:**

This limited warranty is valid only in the United States of America. The warranty is not transferable and extends only to the original purchaser. This warranty only applies to situations classified as owner-occupied. This limited warranty applies only where the affected area is visible and covers an area greater than two square inches. The flooring must be installed in accordance with Inspired's recommended installation instructions. This limited warranty shall not apply to damage arising from any of the following:

- **Damage from wheel chairs, wheels, castor chairs, chair legs, and other non-foot traffic.**
- Accidents, abuse or misuse.
- Exposure to extreme heat or steam.
- Improper Installation.
- Installation to uncontrolled climate areas.
- Installation in areas without appropriate window coverings.
- Installation outside of a residential structure (e.g., deck, 3 seasons).
- Accidental damage (such as impacts, dents or slices).
- Improper cleaning, care and maintenance including use of improper cleaners with wax.
- Freight.
- Modification, alterations, repair, or service by a non authorized floor covering dealer.
- Excessive or prolonged water damage.
- Damage due to failure to use appropriate chair pads.
- Damage resulting from or in connection with subfloor or concrete slab conditions.
- Damage resulting from excessive wear, abuse, or use. Installed flooring in bathrooms, laundry rooms or areas with excessive moisture (indirect or direct).
- Scratches or dents as a result of misuse or site conditions (e.g., gravel driveway).

### **Please Note:**

This warranty excludes any visual defects apparent after installation of floor, as it is the responsibility of the Owner/Installer to inspect all product at time of purchase / installation. Inspired does not grant to any person or entity the authority to create for it any obligation or liability in connection with this product. Inspired shall not be liable to the consumer or any other person or entity for any incidental, special, or consequential damages, arising out of breach of this limited warranty or any implied limited warranty (excluding merchantability). All implied warranties are hereby limited to the duration of this limited warranty. Some states do not allow the exclusion or limitation of implied warranties or the limitation of incidental or consequential damages, so the above limitations or exclusions may not apply to the purchaser. This warranty gives the purchaser specific legal rights, such rights may vary from state to state. Inspired reserves the right to designate a representative, inspector or flooring professional to inspect the floor at issue and remove any necessary samples for analysis.

20260310





# Independence Park

## 15 year SPC Warranty

### **What this Residential Limited Warranty covers:**

Inspired warrants that from the date of the original purchase throughout the length of the warranty (15 years) of the product you purchase, your SPC Floor:

- Will not stain
- Will not wear through (20 MIL wearlayer)
- Will not fade as a result of direct sunlight or artificial light
- Will not absorb water

### **Lifetime Structural Integrity Warranty:**

Inspired warrants to the original purchaser that this laminate product, in its manufactured condition, will be free from defects in material or workmanship including milling, assembly, and dimension. Any damage to the wear layer must be evident and visible measuring at least two (2) square inches. What you should do if any of the above listed problems occur and you need warranty service: You (the original purchaser) should notify the authorized flooring dealer from which the original purchase was made of any defect no later than 15 days after discovering the defect but within the time period of this limited warranty. You (the original purchaser) must present to that authorized flooring dealer the following items for a warranty claim to be considered: A valid proof of purchase in the form of a sales receipt or other documents which establish proof of purchase. A detailed description of the problem and/or a photograph/sample that clearly shows the warranty problem.

### **What Inspired will do should you need warranty service:**

If Inspired honors a claim under this limited warranty, it will repair or replace, at its option, the cost of the affected flooring material only on a pro-rated basis (on original invoice of material only to original purchaser) for the duration of the warranty. The original purchaser shall be responsible for the difference between the replacement/repair amount and the pro-rated amount. If professionally installed, Inspired will pay the reasonable labor costs to perform the replacement or repair during the first one (1) year from the date of the original purchase. In the event that the color installed is no longer available, Inspired will authorize your dealer to replace the affected floor with another Inspired product of equal value and the pro-rated invoice value will be applied to the new Inspired product with the original purchaser being responsible for the difference, if any. The above described remedy is the purchaser's sole and exclusive remedy for claims under this limited warranty.

### **This Limited Warranty is subject to the following conditions:**

This limited warranty is valid only in the United States of America. The warranty is not transferable and extends only to the original purchaser. This warranty only applies to situations classified as owner-occupied. This limited warranty applies only where the affected area is visible and covers an area greater than two square inches. The flooring must be installed in accordance with Inspired's recommended installation instructions. This limited warranty shall not apply to damage arising from any of the following:

- **Damage from wheel chairs, wheels, castor chairs, chair legs, and other non-foot traffic.**
- Accidents, abuse or misuse.
- Exposure to extreme heat or steam.
- Improper Installation.
- Installation to uncontrolled climate areas.
- Installation in areas without appropriate window coverings.
- Installation outside of a residential structure (e.g., deck, 3 seasons).
- Accidental damage (such as impacts, dents or slices).
- Improper cleaning, care and maintenance including use of improper cleaners with wax.
- Freight.
- Modification, alterations, repair, or service by a non authorized floor covering dealer.
- Excessive or prolonged water damage.
- Damage due to failure to use appropriate chair pads.
- Damage resulting from or in connection with subfloor or concrete floor conditions.
- Damage resulting from excessive wear, abuse, or use. Installed flooring in bathrooms, laundry rooms or areas with excessive moisture (indirect or direct).
- Scratches or dents as a result of misuse or site conditions (e.g., gravel driveway).

### **Please Note:**

This warranty excludes any visual defects apparent after installation of floor, as it is the responsibility of the Owner/Installer to inspect all product at time of purchase / installation. Inspired does not grant to any person or entity the authority to create for it any obligation or liability in connection with this product. Inspired shall not be liable to the consumer or any other person or entity for any incidental, special, or consequential damages, arising out of breach of this limited warranty or any implied limited warranty (excluding merchantability). All implied warranties are hereby limited to the duration of this limited warranty. Some states do not allow the exclusion or limitation of implied warranties or the limitation of incidental or consequential damages, so the above limitations or exclusions may not apply to the purchaser. This warranty gives the purchaser specific legal rights, such rights may vary from state to state. Inspired reserves the right to designate a representative, inspector or flooring professional to inspect the floor at issue and remove any necessary samples for analysis.

20260310



inspiredflooring.us

WPC & SPC (water-proof core) vinyl floors are a great option for homeowners looking for an attractive, affordable, durable, and long-lasting alternative to traditional hardwood floors, plus they're 100% waterproof. Learning how to clean and care for your floor will ensure that you continue to enjoy your investment for years.

Here are a few tips to clean and care for WPC / SPC flooring:

WPC/SPC flooring is a low-maintenance material. In other words, you can keep it looking fabulous with an occasional vacuum and damp mop. Dry mop or vacuum your floor before wet cleaning in order to remove as much dust, dirt, and debris as possible. Make sure to clean the baseboards, corners, and under your furniture, as well. Any Swiffer, premoistened cleaning towelette may contain chemicals that will shine or damage your floor. These should be avoided.

It is quite easy to deal with unexpected spills on your WPC/SPC floor. But as with any surface, any spill should be cleaned immediately, as they tend to get harder to deal with the longer they stay. Simply wipe the spills with warm water and a gentle cleaner. There is no need for hard scrubbing or harsh cleaners.

To prevent structural floor failure and damage to the locking system, do not use chairs with wheels or furniture legs without felt protectors; please note that such damage is not covered under warranty. Additionally, excess rolling or use of wheel chairs may damage the locking mechanism (this use is not covered by warranty).

When moving furniture, appliances, or other heavy items across the flooring, it's best to lift, move and put down. Do NOT drag or push across the floor. This is a great way to prevent scuff marks or tears on your floor. In addition, consider using felt pads or vinyl coasters underneath the feet and legs of your furniture to safeguard your floor.

Lastly, the best way to care for your WPC /SPC flooring is by reducing the accumulation of dirt, stains, and abrasions, so you won't need to clean your floor regularly. Consider placing a rug or doormat at the entrance to your home or building to minimize the dirt and grime that goes inside.

**Cleaning with Chemicals:** Damp mop as needed using clean water and a diluted pH Neutral cleaner (Shaw Hard Surface Cleaner). Do NOT use harsh cleaners or chemicals on the floor. Do NOT use abrasive scrubbing tools. Do NOT use detergents, abrasive cleaners or "mop and shine" products. Do not use a steam cleaner.

Do not use vinegar as a cleaning solution, its acidic properties will harm the finish.

Do not use any wood care floor cleaning products on vinyl floors. Self-polishing acrylic waxes can cause the surface to become slippery and appear dull quickly.

Resilient floors are damaged by solvents, only use properly rated cleaners. Oil or petroleum-based products can result in surface staining. Do not track asphalt driveway sealer or automobile oil drips onto the vinyl floor covering. All chair legs must have protective feet.

Black rubber wheels and rubber feet can discolor the floor. Do not expose Inspired floors to temperature exceeding 120° F. Avoid prolonged exposure to direct sunlight as this will result in discoloration and expansion. The use of drapes, blind systems or protective window film is required.

For moderately soiled areas, use a mild solution of isopropyl (rubbing) alcohol and distilled water. Dilute the mixture by mixing one-part alcohol and 2 parts distilled water. For tougher spots, use a higher concentration of isopropyl alcohol and distilled water. Denatured alcohol can be used for adhesive and oil based stain removal.

Vinyl flooring, like other types of smooth floors, may become slippery when wet. Allow time for floor to dry after cleaning. Immediately wipe up wet areas from spills, foreign substances or wet feet.

***Steam cleaners or cleaning with a lot of water or steam will damage your floor and will void warranty coverage.***

### Maintenance Tips:

- Walk-off mats should be used at all entrances to absorb soil and moisture. If mats are placed directly on top of the resilient floors, use mats without latex or rubber backings to avoid possible discoloration.
- Daily removal of dirt and dust is important to prevent particles from abrading the surface of resilient floors. Sweeping, dust mopping, and vacuuming are recommendations to remove soil particles that can result in scratches and worn appearances. Do not use vacuums with rotating beater bars on hard surfaces.
- Absorb wet spills as quickly as possible by blotting with paper or cloth towels. Rinse with water if necessary and blot dry.
- Do not use chairs with castor wheels.



# Warranty, Care and Maintenance

## 2MM / 2.5MM GLUE DOWN LVP

### 6 Year Light Commercial / 15 Year Residential

Inspired Flooring warrants that its Luxury Vinyl Plank Flooring products will be free from manufacturing defects for the length of time specified for the particular product. This warranty further covers delaminating, loss of original pattern and color due to fading or wear, when the flooring is subject to normal residential use, provided the flooring covered by this warranty is installed and maintained according to the instructions included in the original packaging.

#### MAINTENANCE

New floors should not be saturated or wet cleaned for 5 days after installation. Only damp mopping is recommended between installation and the 5-day period. Always protect floors when moving heavy objects to prevent permanent scratches and tears. Allow the recommended minimum of 24 hours before moving heavy objects on newly installed floors. The use of plywood and heavy cardboard are examples of protective barriers. Use appropriate wide floor protectors under tables, chairs, and any other heavy home furnishing to avoid permanent damage. Walk-off mats should be used at all entrances to absorb soil and moisture. If mats are placed directly on top of LVP, use mats without latex or rubber backings to avoid possible discoloration.

Daily removal of dirt and dust is important to prevent particles from abrading the surface of LVP. Sweeping, dust mopping, and vacuuming are recommendations to remove soil particles that can result in scratches and worn appearances. Periodic wet cleaning will be necessary to help maintain the floor's appearance.

Always pre-vacuum or dust mop before any type of wet cleaning. Appropriate vinyl floor cleaning equipment and cleaning agents (neutral pH cleaners) are recommended. Do not use abrasive cleaners or cleaning agents that leave dull residues on the surface of the floors.

Follow the cleaning manufacturer's instructions for damp mopping and application. If rinsing is necessary, use clean water and expedite drying with air movers or fans. Do not use a steam cleaner.

#### TERMS

If, within One (1) Year: a defect covered by this warranty is found and reported to the merchant from which the floor was purchased in writing within one year of purchase, Inspired will supply new flooring material of similar color, pattern, and quality to replace the defective area. Inspired will also pay reasonable labor costs if professional installation was paid for when the floor was originally installed. Further, homeowner shall provide copy of original receipt for flooring to verify product and date of purchase. If, after One (1) Year and prior to expiration of the warranty: a defect covered by this warranty

is found and reported to the merchant from which the floor was purchased in writing after one year but within two years of purchase, Inspired Flooring Company will supply new flooring material of similar color, pattern, and quality to replace the defective area. Inspired will not provide any labor toward installation.

Inspired reserves the right to repair any floor and/or to use its own source to obtain an installer for replacement flooring. If Inspired repairs or replaces a floor as a result of a warranty claim, it is the customer's responsibility to clear, at their own expense, any items placed over the affected areas subsequent to the original installation. In the event that Inspired repairs a floor, this warranty shall remain in effect with respect to such floor.

This warranty applies only to a resident homeowner (owner-occupied) who is the original purchaser of the Inspired LVP products, not to any subsequent homeowner. Further, this warranty does not apply to any multi-unit apartment, condominium, rooming houses or hotels where the owner is not occupying the space.

Darker, solid colors naturally show more scratches and dirt and require more maintenance. We can not warrant the product against these normal occurrences. Inherent in Luxury Vinyl Plank Flooring is expansion and contraction. Please ensure that installation instructions are followed regarding spacing, expansion joints and expansion near interior or exterior walls. Any expansion or contraction of less than 1/8 inch will not be considered a manufacturing defect and therefore is not subject to this warranty. Further, the following are specific exclusions:

- Damage caused by fire or flood; moisture intrusion caused by emissions from subfloor; intentional abuse; damage caused by vacuum cleaner beater bar; indentations or damage caused by improper rolling loads, chairs, or other furniture not using proper floor protectors or caster wheels; cutting from sharp objects; asphalt staining and staining from rubber mats; surface scratches; changes in color or sheen appearance when exposed to a natural light source; exterior application or loss due to inconvenience, loss of time, incidental expenses, or consequential damages.
- Damage caused by improper cleaning methods, including incorrect cleaning agents and/or steam cleaning.
- Minor shading, color, or texture differences between samples and delivered product.
- Minor (<1/8") expansion and contraction of the plank at the joint/seam is expected and inherent with LVP and will not be considered a manufacturing defect.
- If, prior to installation, Inspired's LVP floors are not acclimated to room temperature (between 65°F and 85°F) at job site between 24 and 48 hours, and if, post-installation, Inspired's LVP floors that are not continuously maintained at such temperature, damage incurred may not be covered by your warranty.

Failure to install pursuant to installation instructions or product specification sheet. Failure to use appropriate adhesive, conduct proper floor prep will void entire warranty.



# SPECIFICATIONS

DISC- Discontinued  
Limited- Limited Quantities

CASCADE PARK			VINYL	FloorScore Certified
Thickness (Overall)	Installation Method	Wear Layer	Warranty	Surface Texture
2 MM or 2.5 MM	Glue Down	20 MIL / 12 MIL	15 Years	EMBOSSSED
Style Number	Color Name	2 MM Sq. ft. / Carton	2.5 MM Sq. ft. / Carton	Plank Dimensions (in)
VP025-	Cayman - same as Crawford	41.44	42	6.18 x 48.03
VP25-34	Vegas - same as Victoria	41.44	42	6.18 x 48.03
VP02-77	Butternut - same as Sandlewood	45.32	42	6.8 x 48.03
VP02-65	Hilltop same as Oceanview	41.44	42	6.18 x 48.03
VP02-33	Colorado - same as Prescott	41.44	42	6.18 x 48.03
VPO-99	Montana	41.44	42	6.18 x 48.03
	Summerset - same as Summerset	41.44	42	6.18 x 48.03
	Napa - same as Napa	41.44	42	6.18 x 48.03

INDEPENDENCE PARK				SPC
Thickness (Overall)	Underlayment Foam	Wear Layer	Warranty	Surface Texture
5 MM	1 MM IXPE ATTACHED	20 MIL*	15 YEARS	EMBOSSSED
		Slip Rating	Fire Rating	Sound Rating
		DS	B-s1	67 db
Style Number	Color Name	Sq. ft. / Carton	Plank Dimensions (in)	
S470-82	Alta *	23.68	7x48	Unilin Locking Mechanism
	Steamboat	23.68	7x48	FloorScore
S460-84	Telluride *	23.38	7 x 48	Painted Micro v-bevel
S460-83	Vail *	23.38	7 x 48	
S460-87	Tahoe	23.38	7 x 48	
S460-86	Panorama	23.38	7 x 48	
S460-85	Centennial	23.38	7 x 48	
S460-89	Aspen	23.38	7 x 48	* Independence Park II and Independence Park are 20 MIL wearlayer
S490-91	Norway - LIMITED	23.38	7x48	
S450-17	Stockton - LIMITED	23.38	7x48	

20260311



# SPECIFICATIONS

DISC- Discontinued  
Limited- Limited Quantities

LIBERTY PARK				SPC
Thickness (Overall)	Underlayment Foam	Wear Layer	Warranty	Surface Texture
6.5 MM	15 MM IXPE ATTACHED	20 MIL	15 YEARS	EMBOSSSED
		Slip Rating	Fire Rating	Sound Rating
		DS	B-s1	67 db
Style Number	Color Name	Sq. ft / Carton	Plank Dimensions (in)	
S500-22	Hilldale	23.64	7.08 x 48	
S500-49	Monterey	23.64	7.08 x 48	
S510-68	Crawford	23.79	7.08 x 60.43	FloorScore
S510-17	Summerset	23.79	7.08 x 60.43	Unilin Locking Mechanism
S510-36	Bridgewood	23.79	7.08 x 60.43	Painted Micro v-bevel
S520-25	Conway	23.79	7.08 x 60.43	
S520-28	Napa	22.60	9 x 60	
S520-98	Union	23.79	7.08 x 60.43	
W071-52	Everest - LIMITED	23.79	7.08 x 60.43	
W071-79	Cabin - LIMITED	23.79	7.08 x 60.43	
W072-07	Spyglass II	23.79	7.08 x 60.43	
W075-32	Prescott	23.79	7.08 x 60.43	
W001-04	Ashford II	23.79	7.08 x 60.43	
W001-12	Paradise - LIMITED	23.79	7.08 x 60.43	
W001-15	Barclay - LIMITED	23.79	7.08 x 60.43	
W002-03	Worthington II	25.08	6.42 x 47	
W002-14	Sandlewood II	25.08	6.42 x 47	
W002-66	Grande Reserve II	25.08	6.42 x 47	
W004-60	Oceanview II	23.79	7.08 x 60.43	
W005-45	Westport - LIMITED	23.64	7.08 x 48	
W005-46	Gibraltar - LIMITED	23.64	7.08 x 48	
S540-05	Coastline	22.6	8.98 x 60.43	
S540-06	Nantucket	22.6	8.98 x 60.43	
S540-	Victoria	22.6	8.98 x 60.43	

20260311



# TRANSITIONS

The following transitions are available in all Liberty Park and Independence Park

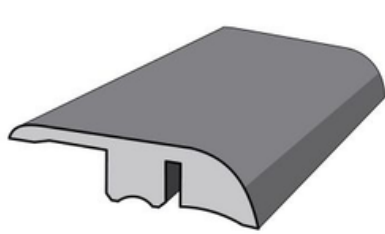

**Reducer**  
1.5"x95"

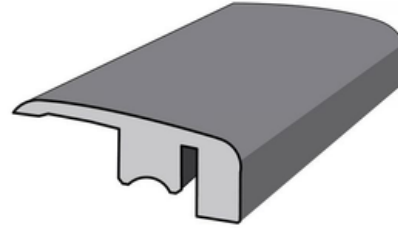

**End Cap**  
1.5"x95"

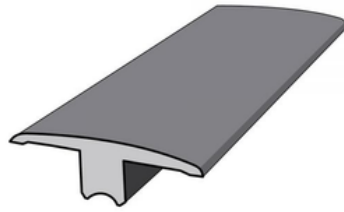

**T-Mold**  
1.5"x95"

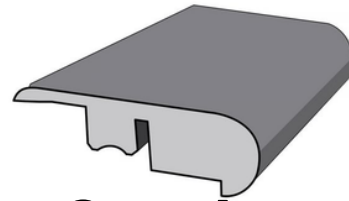

**Overlap  
Stairnose**  
2.5"x95"

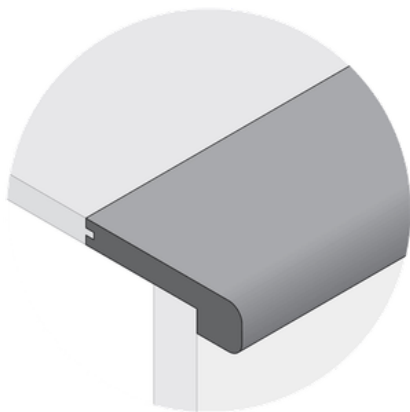

4.5"x72"

Flush mount stairnosing are available in some Liberty Park and Independence Park  
Colors including:

Hilldale, Bridgewood  
Paradise, Telluride  
Prescott, Summerset  
Conway, Ashford, Vail, Monterey  
Alta, Spyglass, Keystone, Coastline  
Nantucket, Aspen  
Tahoe, Panorama, Centennial

Stair-treads are available in select Liberty Park and Independence Park colors. Please check with retailer.